Meeting: Traffic Management Meeting
Date: 14th December 2010
Subject: Proposed Speed Cushions, The Grove, Houghton Conquest

Report of: Basil Jackson, Assistant Director of Highways and Transportation

Summary: The purpose of this report is to present to the Portfolio Holder for Safer and Stronger Communities the result of consultation on the proposal to construct two pairs of speed cushions on The Grove, Houghton Conquest and seek approval for implementation of the scheme.

Contact Officer: David Brown
david.brown@amey.co.uk

Public/Exempt: Public

Wards Affected: Houghton Conquest

Function of: Council

CORPORATE IMPLICATIONS

Council Priorities:

To improve Highway Safety and facilitate the free flow of traffic

Financial:

The construction of this scheme is estimated to cost approximately £13500.

Legal:

None as a result of this report.

Risk Management:

None as a result of this report.

Staffing (including Trades Unions):

None as a result of this report.

Equalities/Human Rights:

None as a result of this report.

Community Safety:

Will improve road safety on this section of highway.

Sustainability:

None as a result of this report

RECOMMENDATION(S):

- 1. That the proposal to construct two pairs of Speed Cushions on The Grove, Houghton Conquest be implemented as set out in this report**

Locations

1. Approximately 1m east of the property boundary between Nos 50 and 52 The Grove
2. Approximately 11m west of the property boundary between Nos 60 and 62 The Grove.

Background and Information.

1. Concerns were raised about the traffic speeds approaching the new 20mph zone in Houghton Conquest. It was felt that this issue could be detrimental to the safety of residents, pedestrians and other motorists. Houghton Conquest Parish Council instructed Bedfordshire Highways Transportation Section to investigate remedial measures.
2. The subsequent investigation and traffic survey substantiated the Parish Council's concerns and Speed Cushions, and enhancement of the gateway feature was proposed to reduce the current hazard.
3. A plan was produced to initiate statutory consultation (See Appendix A)
4. A statutory consultation was undertaken in September 2010 with all stakeholders, including letters delivered to all residents in the vicinity of the proposals. The public notice (See Appendix B) was posted on site and published in the Beds on Sunday on 05/09/10.
5. As a result of this consultation, one objection was received (See Appendix C). The summary of the comments are listed below:
 - 5.1. I object to the humps, but mostly I totally 100% categorically object to the post that is on your plan to be placed in my front garden.
 - 5.2. I have looked after this piece of front garden for the last 30 years and never ever has it been treated or cut by the Council.
 - 5.3. I already have a lamp post at the beginning of my drive which fortunately is between mine and 17a but nevertheless it is a post and I certainly don't want to look out of my window and see yet another post blocking my view.
 - 5.4. I suggest you put it on the spare large bit of land on the opposite side of the road, namely Grange Close.

Conclusions and the Way Forward

6. Whilst the objector states that he objects to the cushions, it is unclear from his letter what his grounds for objecting are. His main concern appears to be related to the positioning of the traffic sign. Hence, we wrote to the objector explaining our position, clarifying the sign position, and asking him to confirm the grounds for objecting to the speed cushions. The main points included in our letter are as follows, and a copy is included in Appendix C:
 - 6.1. The location of the post on the plan was indicative and during detailed design a more suitable location has been established, adjacent the property boundary between No's 15 and 15a. The residents have been consulted by the Parish Council, and have raised no objection to the location of this sign.
 - 6.2. Speed cushions alongside an enhanced gateway feature would encourage traffic to slow down approaching and immediately upon entering the village. Following the proposed cushions there is a bend in the road, which acts as a natural speed reduction feature, thus encouraging traffic to remain at low speed. This is then followed by the feature entrance to the 20mph zone and further bends, already accepted as natural speed reducing features within the 20mph zone.
 - 6.3. Should you wish your objection to the speed cushions to still be considered I would be obliged if you could confirm the grounds on which it is based so that we may have the opportunity to consider/address them.
7. No further response has been received.
8. No written responses were received in favour of the proposal, but we did receive one phone call of support from a resident of The Grove.
9. The proposed course of action is to implement the proposals as advertised (with the revised sign location), for two pairs of speed cushions, and enhancement of the gateway feature, subject to Committee/Portfolio Holder approval.

Appendices

Appendix A: Drawing No. 404396-001-001

Appendix B: Public Notice

Appendix C: Correspondence

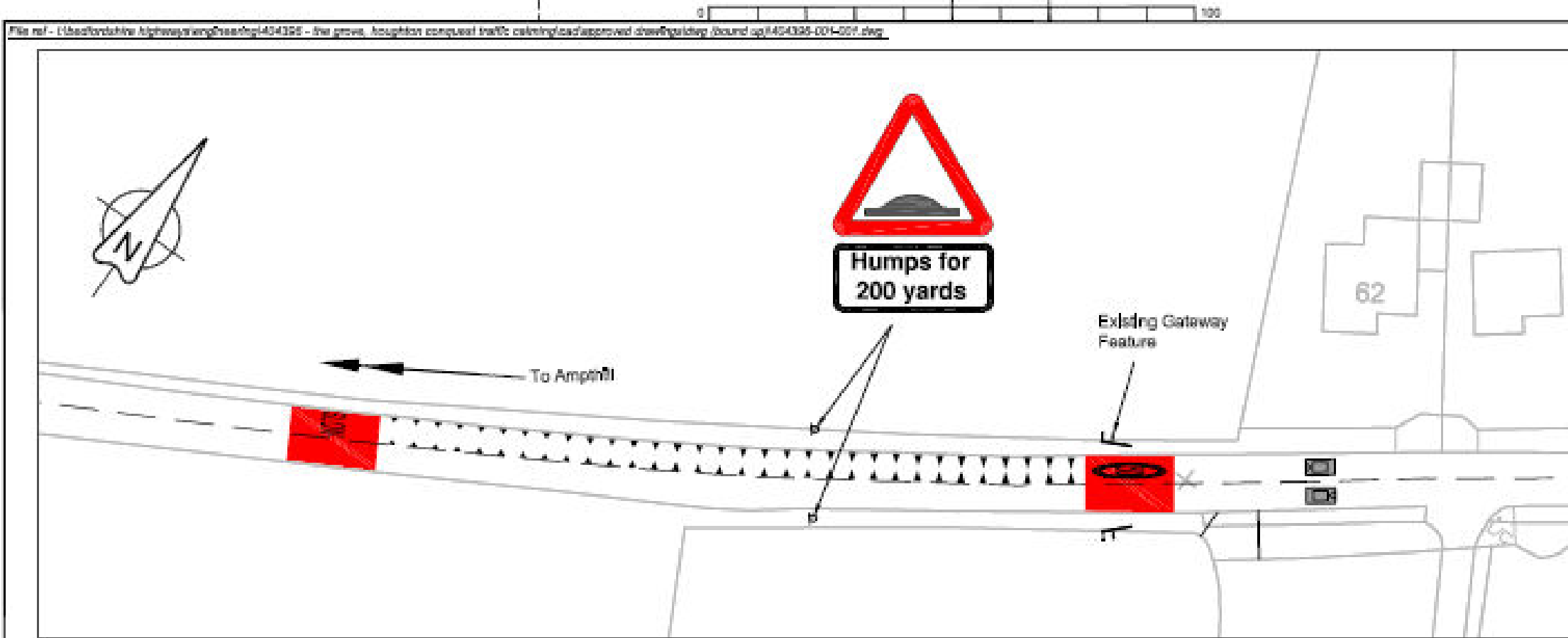

Notes

- Existing Gateway feature to be enhanced.

Key

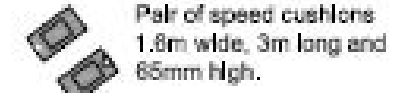

⊗ uc Existing Lighting Column



Reproduced from the Ordnance Survey Map with the permission of the Controller of Her Majesty's Stationery Office. Crown Copyright reserved. Licence No. 100018318

© C.B.C.

| Rev | Revision details | Chkd | Appd | Date |
|-----|------------------|------|------|------|
| | | | | |

| | | | |
|--------|----------|------------------|---|
| Drawn | CB | Preliminary | |
| Design | CB | For comment | |
| Check | SH | For tender | |
| Appd | NC | For construction | |
| Date | 09/08/10 | As constructed | |
| | | Construction | ✓ |

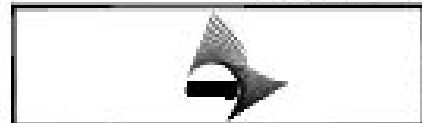

Project Name
**Houghton Conquest
Traffic Calming**

Drawing Title
**Bedford Highways - Transportation
The Grove - Proposed
Traffic Calming**

Original Drawing Size: A3
Scale: 1:1500 Dimensions: m

| Drawing No | Rev |
|----------------|-----|
| 404396-001-001 | - |

PUBLIC NOTICE

HIGHWAYS ACT 1980

PROPOSED TRAFFIC CALMING MEASURES

THE GROVE, HOUGHTON CONQUEST

CENTRAL BEDFORDSHIRE COUNCIL propose to construct traffic calming measures under Section 90 A-I of the Highways Act 1980 and all other enabling powers, in The Grove, Houghton Conquest to reduce vehicle speeds and improve road safety and the environment for local residents.

The proposed traffic calming measures will be:

2 pairs of Speed Cushions, 1.6m wide by 3.0m long (including ramps) and 65mm high, set approximately 0.8m apart.

All associated signage.

The proposed locations of the speed cushions in The Grove, Houghton Conquest are as follows:

1. Approx 1m east of the property boundary between Nos 50 and 52 The Grove.
2. Approx 11m west of the property boundary between Nos 60 and 62 The Grove.

Further Details: of the proposals and a plan can be examined during normal office hours at Central Bedfordshire Council, Technology House, 239 Ampthill Road, Bedford, MK42 9QQ and normal opening hours at Ampthill Library, Dunstable Street, Ampthill, MK45 2NL. Tel: David Brown on 0845 365 6026 for further advice on these proposals.

Objections: should be sent in writing to the Orders & Commons Registration Officer, Countryside Access Service, Central Bedfordshire Council, Technology House, 239 Ampthill Road, Bedford, MK42 9QQ, stating the grounds on which they are made by 27 September 2010.

Technology House
239 Ampthill Road
Bedford MK42 9QQ

Basil Jackson
Assistant Director for Highways

5 September 2010



Appendix C – Correspondence

Dear Sirs

OBJECTIONS

Proposed Traffic Calming Measures - The Grove, Houghton Conquest, Bedfordshire

With regard to the above plan you have sent me as to the proposed traffic calming measures "speed humps", I object to the humps, but mostly I totally 100% categorically object to the post that is on your plan to be placed in my front garden!

I have looked after this piece of front garden for the last 30 years and never ever has it been treated or cut by the Council. I assume therefore that this piece of land is mine.

You now propose to stick a post in it. I already have a lamp post at the beginning of my drive which fortunately is between mine and 17a but nevertheless it is a post and I certainly don't want to look out of my window and see yet another post blocking my view!

I suggest you put it on the spare large bit of land on the opposite side of the road, namely the corner of Grange Close which is a more sensible place as coming out of the village on this road, there is a slight bend so it is not going to be very visible to drivers and therefore not an appropriate place to put it.

Yours faithfully

Appendix C – Correspondence



**Woodlands Annexe
Manton Lane
Bedford
MK41 7NU**

Switchboard 0845 365 6000
Facsimile 0845 365 6001

www.amey.co.uk
www.bedfordshire.gov.uk

27th October 2010

Proposed Speed Cushions – The Grove, Houghton Conquest

Dear,

Thank you for your letter of objection dated 6th September 2010 with regard to the proposed speed cushions in The Grove. Your objection to the location of the sign and post as indicated on the plan is understandable, however the location on this plan was indicative and during detailed design a more suitable and sympathetic location has been established.

In your letter, it is not entirely clear upon what basis you wish to object to the speed cushions, therefore I would like to take the opportunity to outline some more details about the scheme.

The aim of this scheme, defined by Houghton Conquest Parish Council, is to reduce traffic speeds entering Houghton Conquest via The Grove. A number of different traffic calming measures have been considered for application, but speed cushions have been proposed as they offer the most effective and appropriate solution for reducing traffic speeds along this section of highway.

Speed cushions alongside an enhanced gateway feature would encourage traffic to slow down approaching and immediately upon entering the village. Following the proposed cushions there is a bend in the road, which acts as a natural speed reduction feature, thus encouraging traffic to remain at low speed. This is then followed by the feature entrance to the 20mph zone and further bends, already accepted as natural speed reducing features within the 20mph zone.

The location we are proposing for the aforementioned post and sign is in line with the property boundary between no's 15 and 15a. We have consulted with the residents of these properties and can confirm that, should the scheme proceed, then this would be the location of this sign.

Should you wish for your objection to the speed cushions to still be considered I would be obliged if you could confirm the grounds on which it is based so that we may have the opportunity to consider/address them.

Should you wish to discuss the proposals further, or require further information, please contact David Brown at Bedfordshire Highways, Woodlands Annexe, Manton Lane, Bedford MK41

Appendix C – Correspondence

7NU, or telephone 0845 365 6026, or e-mail: David.brown@amey.co.uk.

Yours Faithfully

Nick Chapman
Transportation Manager